

GW-150 INTELLIGENT TWIST-LOCK CONTROL SPECIFICATIONS

The GW-150 is a wireless energy-saving intelligent controller used in the wireless lighting control system. The core components utilize an ARM control chip and one-line wireless communication module.

The GW-150 controller meets IEEE802.15.4 protocol for wireless communication and benefits from flexible networking, strong anti-interference/long-distance communication. The GW-150 utilizes a Mesh network in a reticular or star like structure.

The GW-150 controller contains an exclusive watt-hour meter chip for the measurement of current, voltage, and power usage of luminaires, the real-time collection of working status and power consumption of luminaires, the timely feedback of luminaire field conditions, and intelligent regulation with real-time responses.



FEATURES

- Remote ON/OFF switch, dimming of luminaire
- Remote monitoring of voltage, current, and power usage
- Single-fixture or several-fixture



GW-150 INTELLIGENT TWIST-LOCK CONTROL SPECIFICATIONS (CONT.)

FEATURES (CONT.)

- 85-305VAC voltage range
- Standard interface
- IP65 protection

TECHNICAL INFORMATION

Input	Voltage range	85-305VAC
	Working frequency	47-63Hz
	Current range	0-5A
	Standby power consumption	≤2W
Parameter test	Voltage range	85-305VAC
	Detection accuracy	≤2%
	Current range	0-4A
	Detection accuracy	≤2%
Dimming output	PWM	5V/400Hz (optional)
	0-10V	0-10V (standard)
Communication	Communication mode	wireless
	Modulation mode	DSSS
	Working frequency	2405-2485M standard ISM frequency band
	Receiving sensitivity	-100 dbm ~ -94dbm
	Transmission distance	1,000m (unimpeded view in open area)
Antenna parameters	Working frequency	2400 ~ 2500 MHz
	Standing wave ratio	≤ 1.5
	Antenna gain	2.5 DBi
	Input impedance	50Ω
	Interface type	SMA interface
	Antenna type	Glue stick antenna
Working environment	Working temperature	-40~+80℃
	Ambient humidity	20~90%RH (no condensation)
	Storage environment	-40~+85℃, 10~90%RH
Safety (PENDING)	Safety regulation clauses	UL8750, EN61347-1, CLASS

GW-150 INTELLIGENT TWIST-LOCK CONTROL SPECIFICATIONS (CONT.)

Safety (cont.)		2,IP65,UL60950-1
	Isolation voltage	AC to dimming end, 3.75KVAC
	Isolation resistance	AC to dimming end >50MΩ at 500VDC
	Electrostatic discharge	IEC/EN 61000-4-2 Contact ±4KV/Air ±8KV
	Burst of pulses	IEC/EN 61000-4-4 ±4KV
	Lightning and Surging	IEC/EN 61000-4-5 L-L line 4 kV
Other	Ingress Protection	IP65

DIMENSIONS

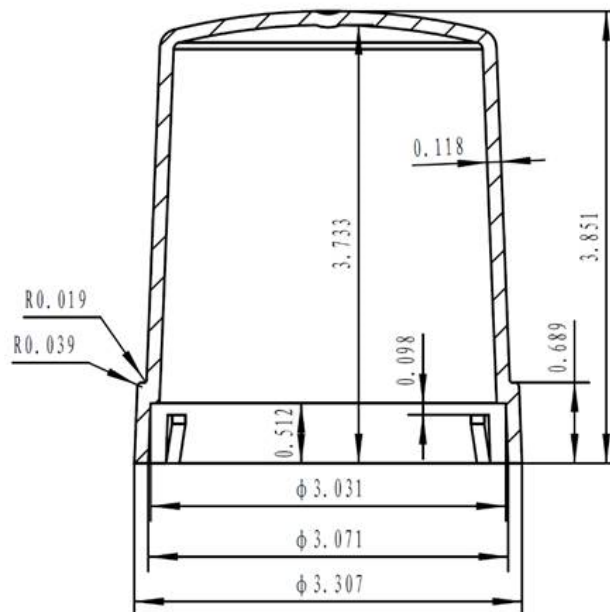

Units: Inches

GW-150 INTELLIGENT TWIST-LOCK CONTROL SPECIFICATIONS (CONT.)

WIRING DIAGRAM

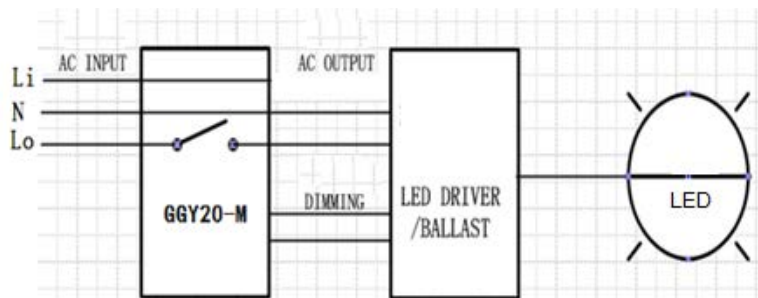

INTERFACE

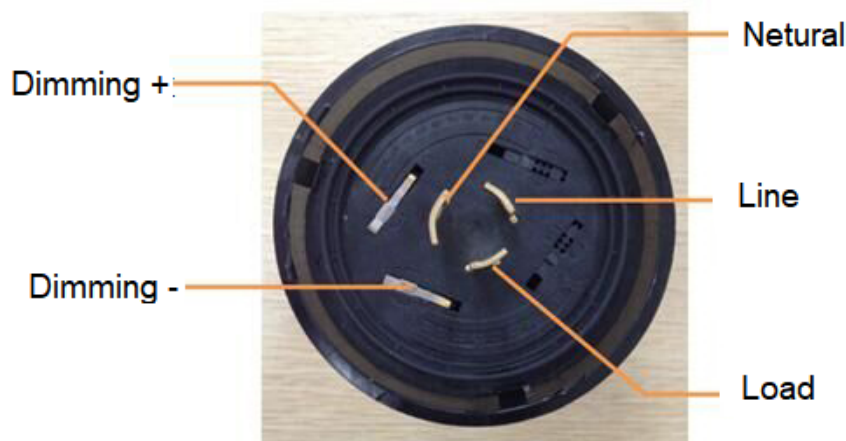

WARRANTY

10 year warranty - All photocontrols are marked with date of manufacture. This product is warranted to operate within its original specifications and shall be free of electrical or mechanical defects. Manufacturer's warranty shall be limited to providing a replacement control of same type and shall not cover costs of removal, replacement or loss of service nor any consequential damages. This warranty is in lieu of and excludes all other warranties either expressed or implied. Full warranty statement is available by consulting factory.

DISCLAIMER

UL certifications and patents are pending